

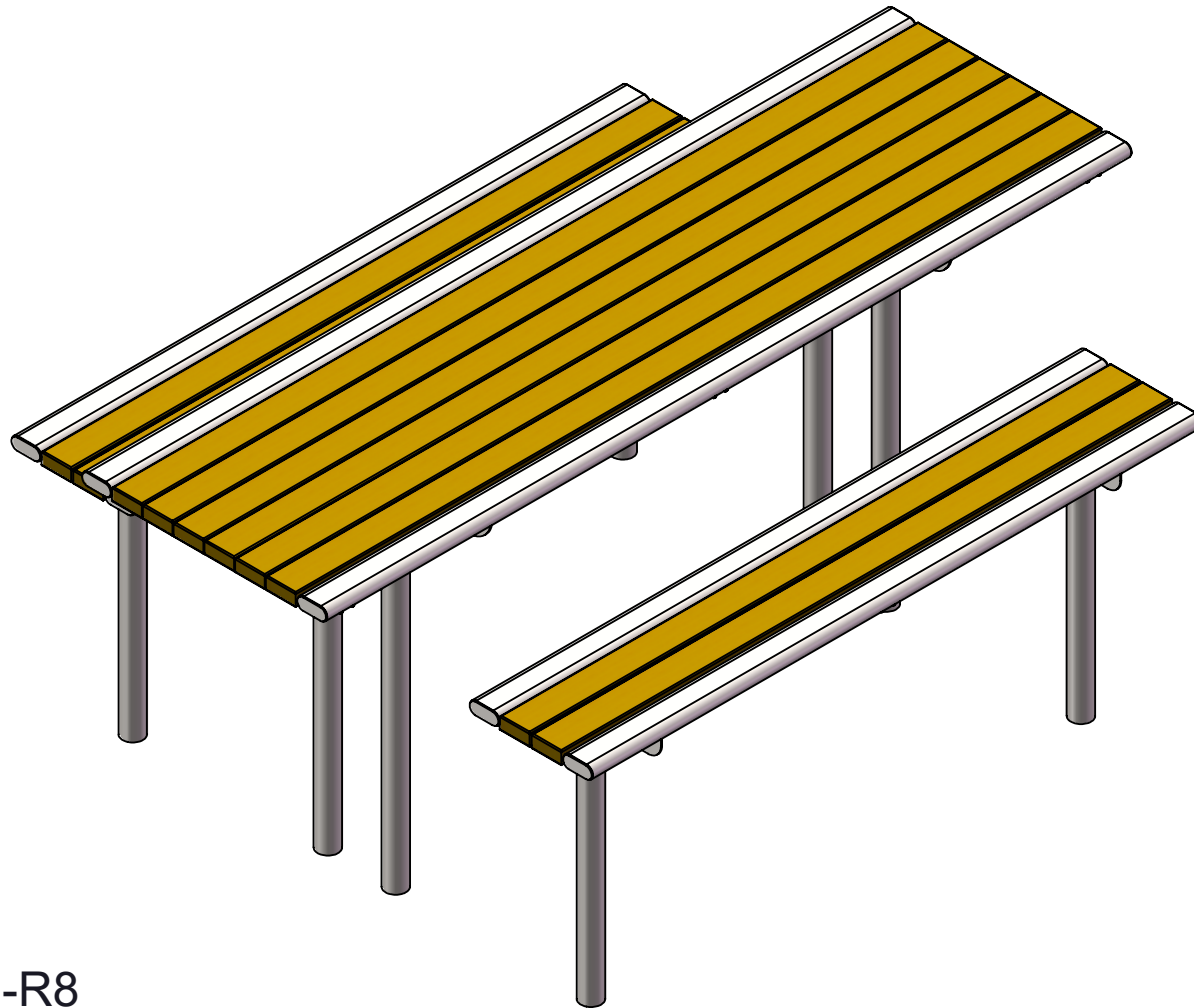

A **PLAYCORE** Company



Model # 63SH-R8



A PLAYCORE Company

SAFETY WARNINGS & EQUIPMENT INSPECTION

- Owners and installers please note these safety warnings and make use of this checklist on a regular basis.
- Follow installation instructions when erecting equipment.
- Ground surfaces around equipment should be restored as needed. Concrete footings should never be exposed. Surface depth should comply with ASTM and CPSC specifications.
- Check for and repair damage caused by wear or vandalism, a major factor in injury causing situations.
- All protruding bolts should be covered or cut off and finished smooth. Sharp edges on pipes should be capped or removed. Check for bent, broken, or severely worn pipe, and replace.
- All equipment should be free of rust and repainted whenever necessary to deter rusting.
- We provide our customers with layout sheets and installation instructions. Please keep on file the specifications sheet that contains the listing of every part used.
- Never add components not intended for use with this product.
- Regular maintenance is necessary in this and all park and recreational equipment to insure the safety of the user.
- Note: Proper maintenance of equipment requires regular tightening of all bolts, nuts, and setscrews.
- Note: Regular checking of all parts, castings, etc. should be made. If a part is broken or worn, it should be replaced immediately.
- Check to be sure all fittings are tight and that bars and pipes do not move.
- Replace all worn S-hooks. S-hooks must be completely closed. Failure to close S-hooks can result in serious injury to the user. NEVER reuse S-hooks.
- Test for free movement of swing hanger and other moving attached parts.
- Check for worn chains and replace them.
- A soft resilient surface should be placed under all swings extending at least twice the height of the top rail both front and back.

HARDWARE



5/16" x 1-1/4"
Lag Bolt

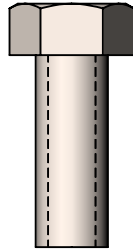

3/18" x 1"
Machine Bolt

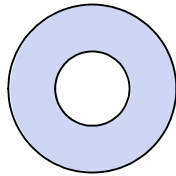

5/16" Flat Washer

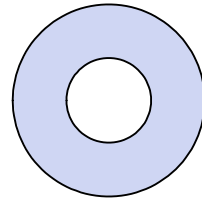

3/8" Flat Washer

TOOLS REQUIRED

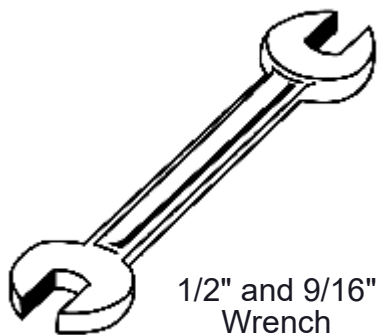

1/2" and 9/16"
Wrench

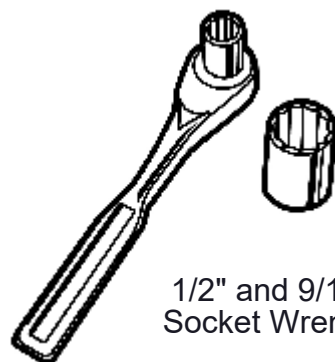

1/2" and 9/16"
Socket Wrench

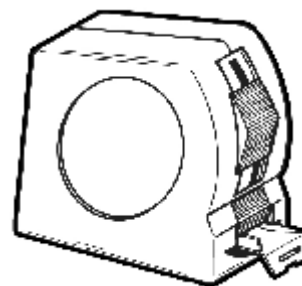

Tape Measure

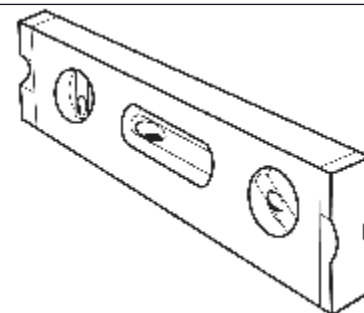

Level

ULTRA SITE PRODUCT SPECIFICATIONS

63SH-R8 INGROUND PICNIC TABLE

Seats & Top: 2x4 planks are made from a minimum of 96% post-consumer or post-industrial recycled plastic. Contains UV stabilizers to prevent fading. End Planks are made from 1-1/2" x 3-1/2" steel oval tubing.

Frame: 2-3/8" x 12 gauge structural steel tubing. Seat and Top supports are fabricated from 10 gauge angle. All electrically MIG welded.

Frame Coating: Steel is sandblasted to near white condition. Coated with zinc rich epoxy primer and top coated with electrostatic powder coat, oven cured.

Hardware: All fasteners are zinc coated.

Dimensions: Table Top is 28 7/8" W x 95" L, 30" from the ground. Seat is 14 1/2" W x 72" L, 18" from the ground. Overall dimensions are 68 1/2" x 95" x 30".

COMPONENTS

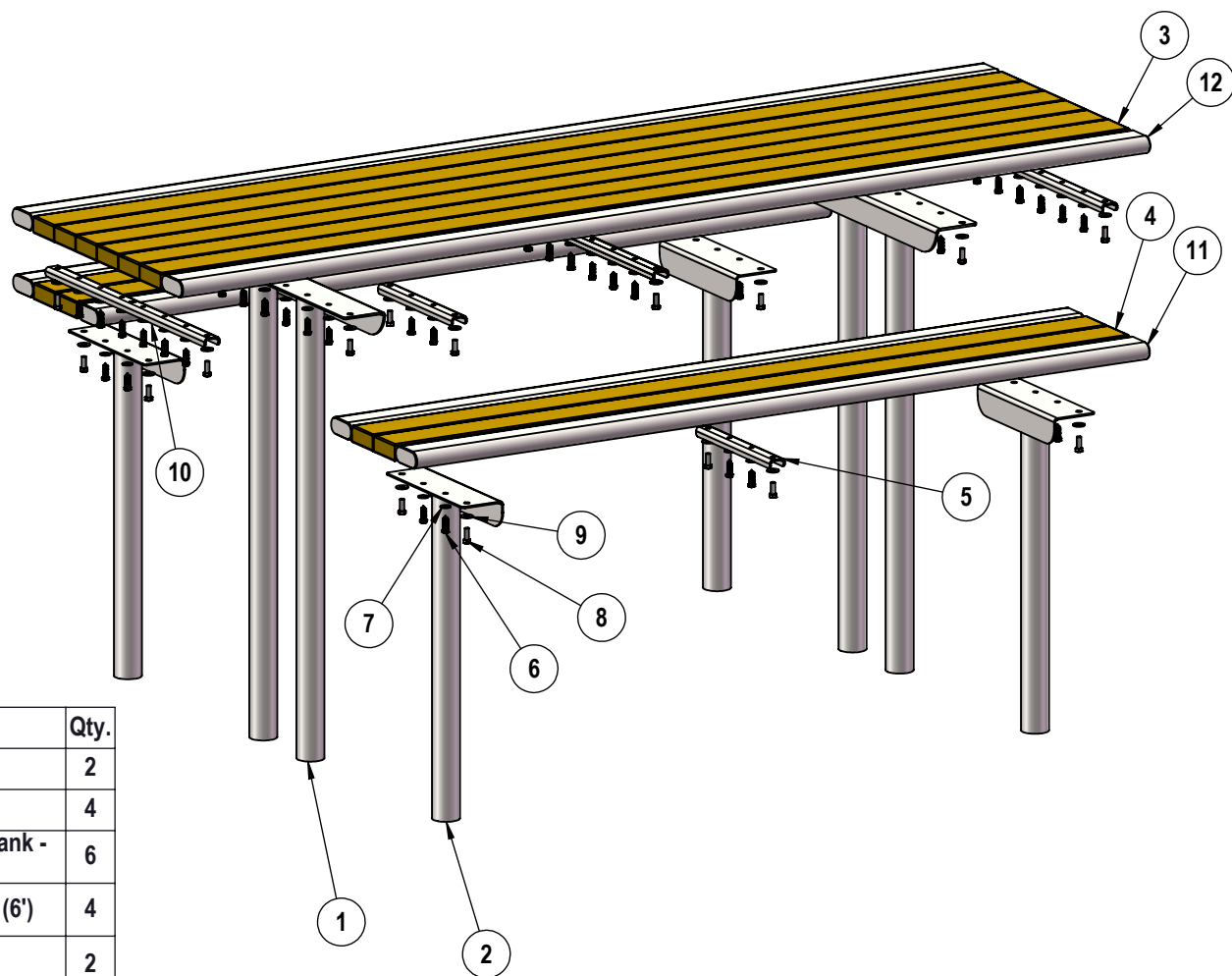

ITEM NO.	PartNo	DESCRIPTION	Qty.
1	P-01-01-0408	63 Series S Table Leg	2
2	P-01-01-0406	63 Series S Seat Leg	4
3	01-01-0593	8' 2x4 Recycled Handicap 64 Table Plank - CDR/BRN/GRN/GRY	6
4	R72-2x4-LB	2x4 Recycled Bench Plank-lag bolts (6')	4
5	P-01-01-0674	63/64 Series Seat Channel	2
6	33-05-0034	5/16" x 1-1/4" lag bolt, SS	48
7	33-02-0007	5/16" SS Washer	48
8	33-06-0056	3/8" x 1" Machine Bolt (SS)	24
9	33-02-0008	3/8" Flat Washer (SS)	24
10	P-01-01-0675	63/64 Series Center Channel	4
11	01-01-0664	6' Oval Tube	4
12	01-01-0677	8' ADA Oval Tube	2

STEP 1

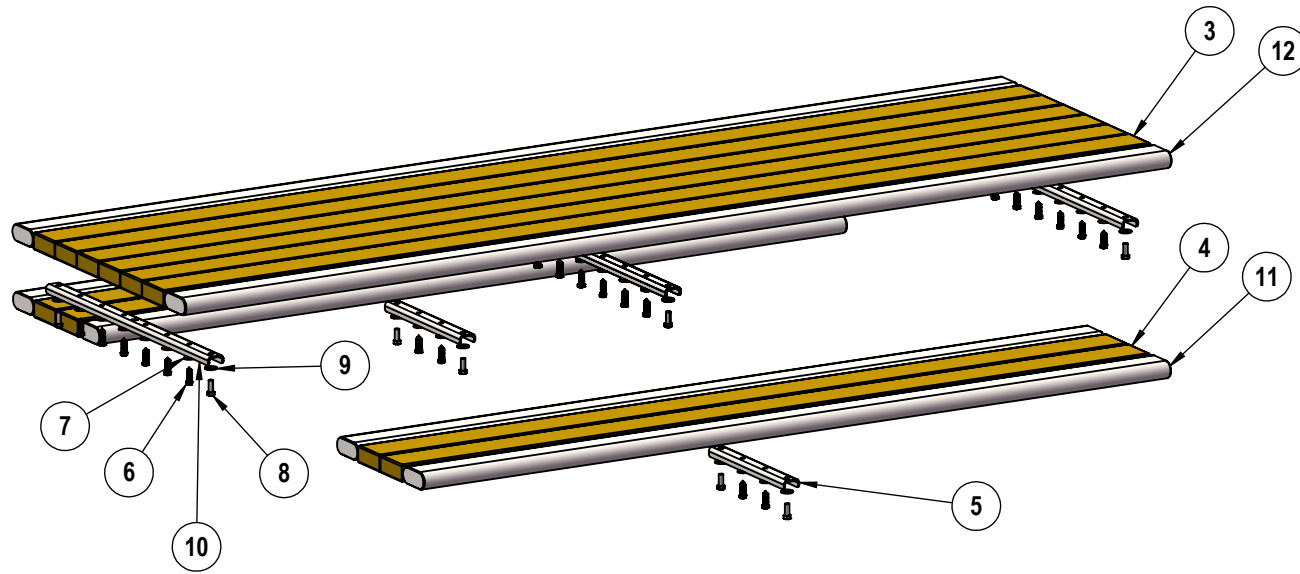

Attach channels to Oval Tubes and Planks using specified hardware

STEP 2

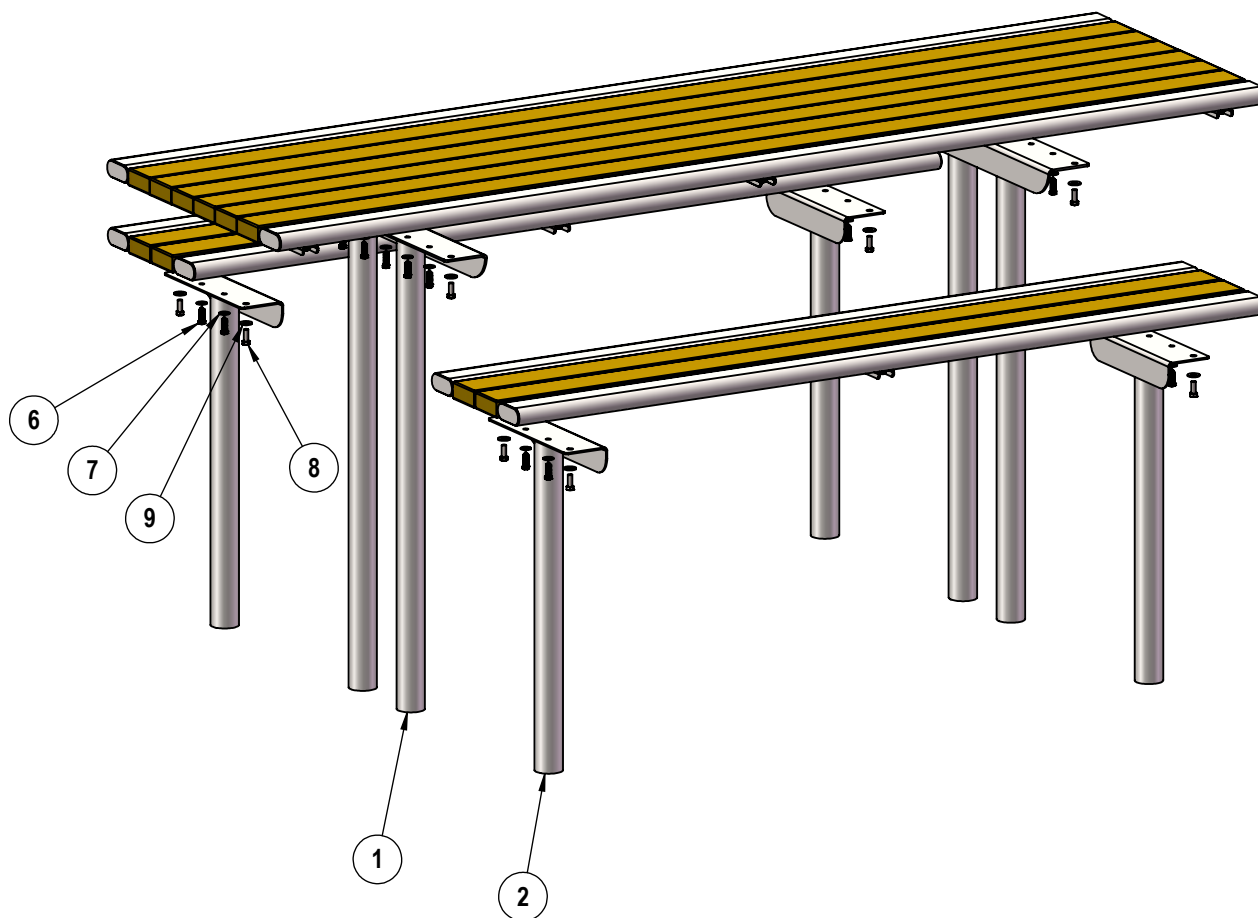

Attach seat and table planks to legs using specified hardware

FOOTING DETAILS

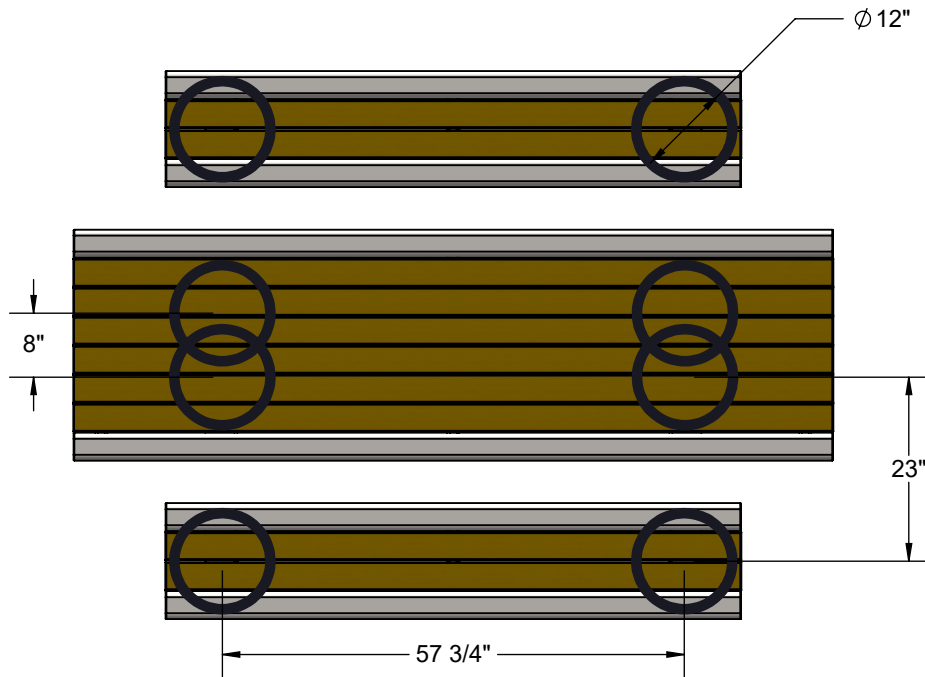

Estimated Required Concrete:
26 - 50lb Bags of Concrete Mix

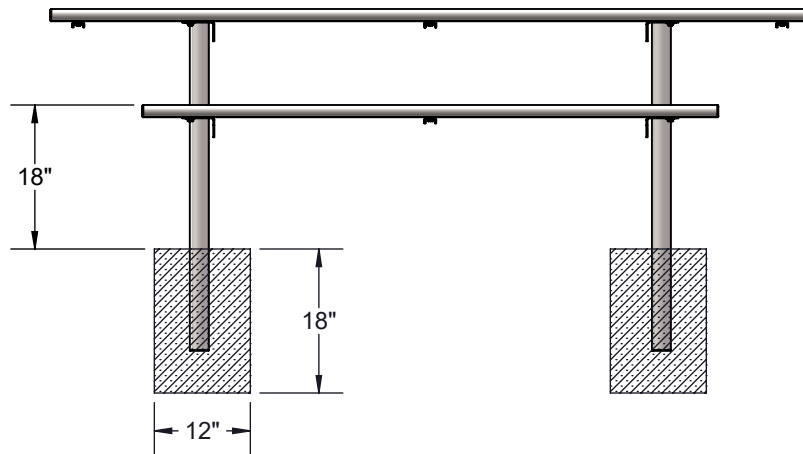

OVERALL DIMENSIONS

