

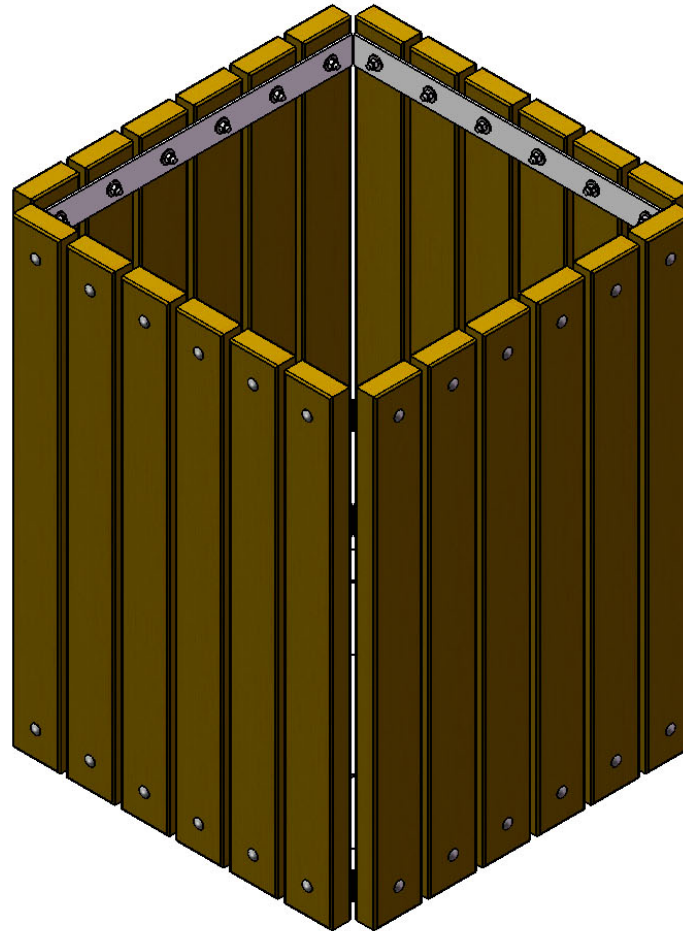

A **PLAYCORE** Company



Model # TRSQ-32-R



A PLAYCORE Company

SAFETY WARNINGS & EQUIPMENT INSPECTION

- Owners and installers please note these safety warnings and make use of this checklist on a regular basis.
- Follow installation instructions when erecting equipment.
- Ground surfaces around equipment should be restored as needed. Concrete footings should never be exposed. Surface depth should comply with ASTM and CPSC specifications.
- Check for and repair damage caused by wear or vandalism, a major factor in injury causing situations.
- All protruding bolts should be covered or cut off and finished smooth. Sharp edges on pipes should be capped or removed. Check for bent, broken, or severely worn pipe, and replace.
- All equipment should be free of rust and repainted whenever necessary to deter rusting.
- We provide our customers with layout sheets and installation instructions. Please keep on file the specifications sheet that contains the listing of every part used.
- Never add components not intended for use with this product.
- Regular maintenance is necessary in this and all park and recreational equipment to insure the safety of the user.
- Note: Proper maintenance of equipment requires regular tightening of all bolts, nuts, and setscrews.
- Note: Regular checking of all parts, castings, etc. should be made. If a part is broken or worn, it should be replaced immediately.
- Check to be sure all fittings are tight and that bars and pipes do not move.
- Replace all worn S-hooks. S-hooks must be completely closed. Failure to close S-hooks can result in serious injury to the user. NEVER reuse S-hooks.
- Test for free movement of swing hanger and other moving attached parts.
- Check for worn chains and replace them.
- A soft resilient surface should be placed under all swings extending at least twice the height of the top rail both front and back.

HARDWARE

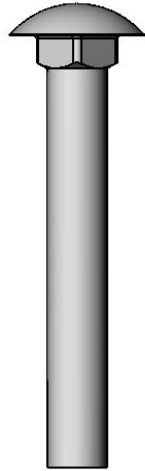

5/16" x 2-1/4"
Carriage Bolt

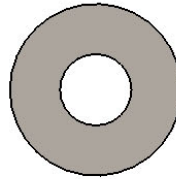

5/16" Washer

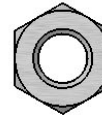

5/16" Hex Nut

TOOLS REQUIRED

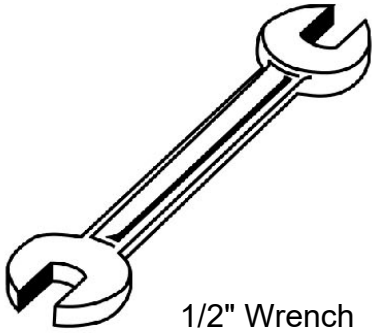

1/2" Wrench

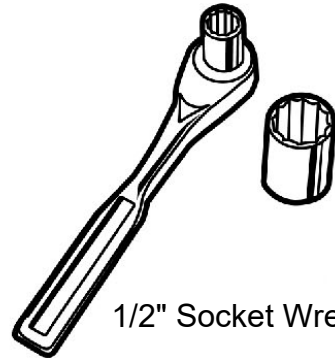

1/2" Socket Wrench

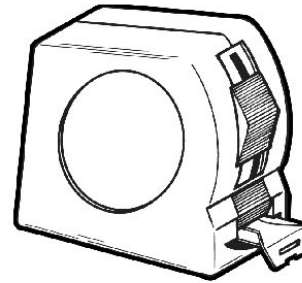

Tape Measure

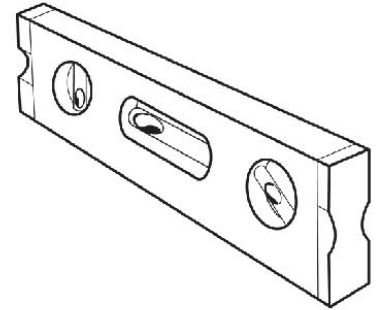

Level

ULTRA SITE PRODUCT SPECIFICATIONS

TRSQ-32-R SQUARE RECEPTACLE

Planters: 2x4 planks are made from a minimum of 96% post-consumer or post-industrial recycled plastic. Contains UV stabilizers to prevent fading.

Frame: 7 gauge. formed steel plate. Bottom plate is 10 gauge. steel.

Frame Coating: TGIC electrostatic powder coated application oven cured, or hot dipped galvanized after fabrication.

Hardware: All fasteners are zinc coated.

Dimensions: 27" square x 34" tall.

COMPONENTS

Attach the 32" Recycled Planks to the Bottom Ring Assembly and the L Bracket Assembly using specified hardware.

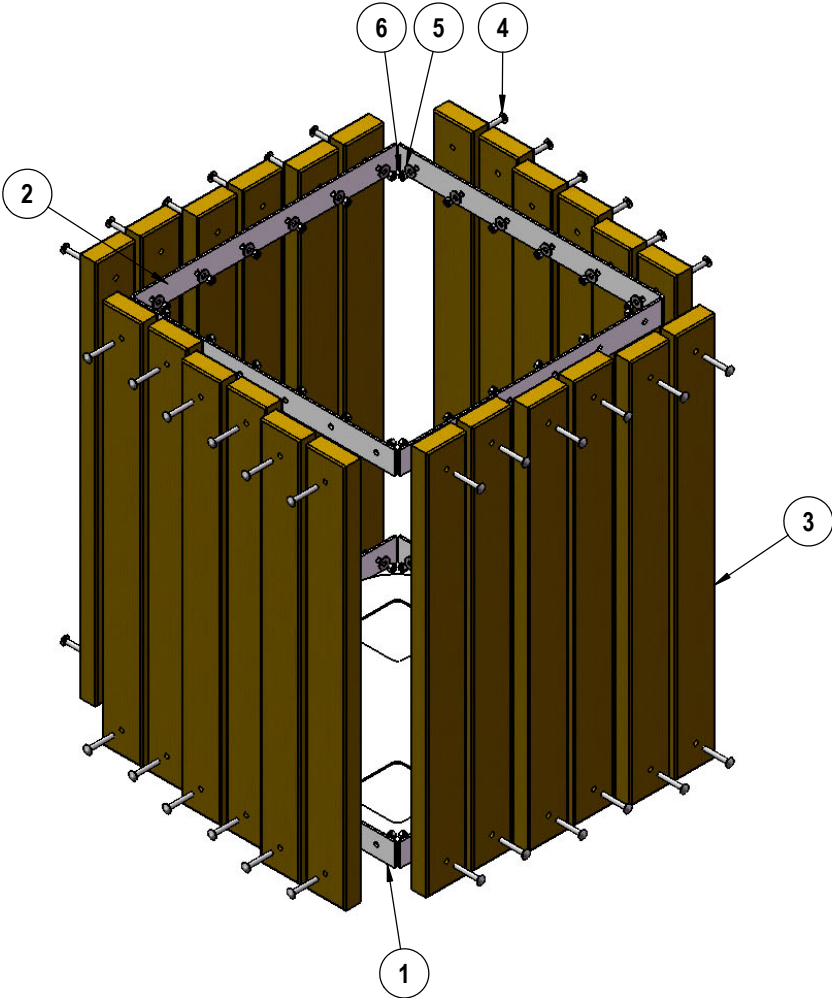

ITEM NO.	PartNo	DESCRIPTION	Qty.
1	01-05-0090	TR Sq. Planter/Receptacle bottom ring assembly	1
2	01-05-0089	TR Sq. Planter/Receptacle L bracket assembly	1
3	XXX34-2x4-TR	2 x 4 Recycled TR Plank (34")	24
4	33-06-0006	5/16" x 2 1/4" Carriage Bolt (Zinc)	48
5	33-02-0001	5/16" Zinc Plated Washer	48
6	33-01-0001	5/16" Hex Nut (Zinc)	48

OVERALL DIMENSIONS

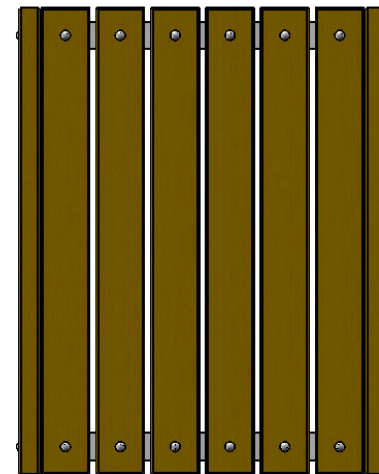
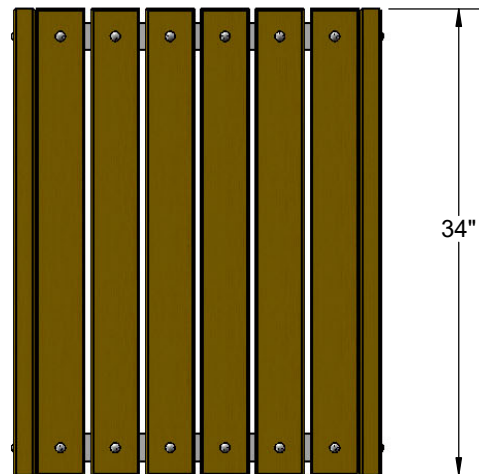
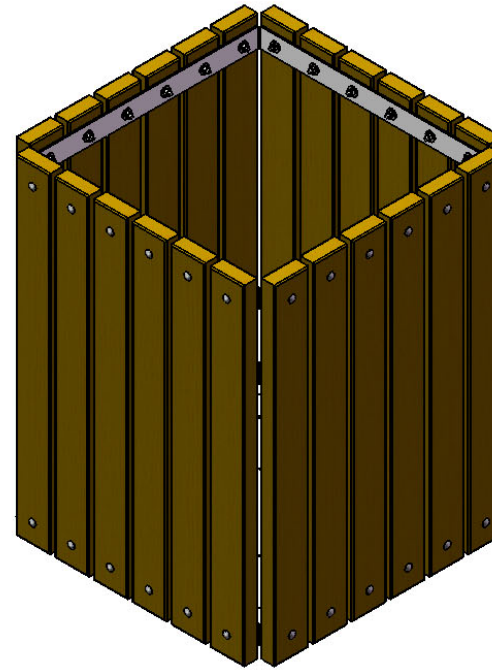
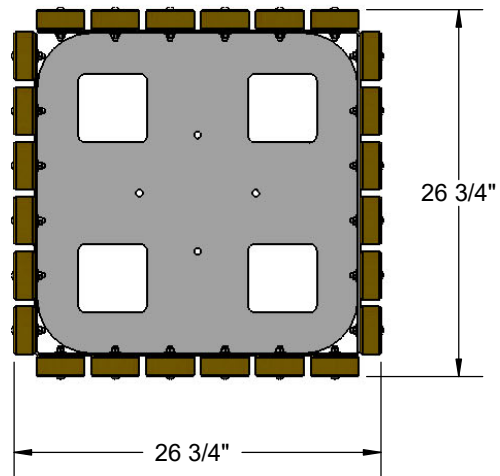

LINER OPTION

PL-32
32 Gallon Liner

Made from heavy duty plastic.
Sold Separately.

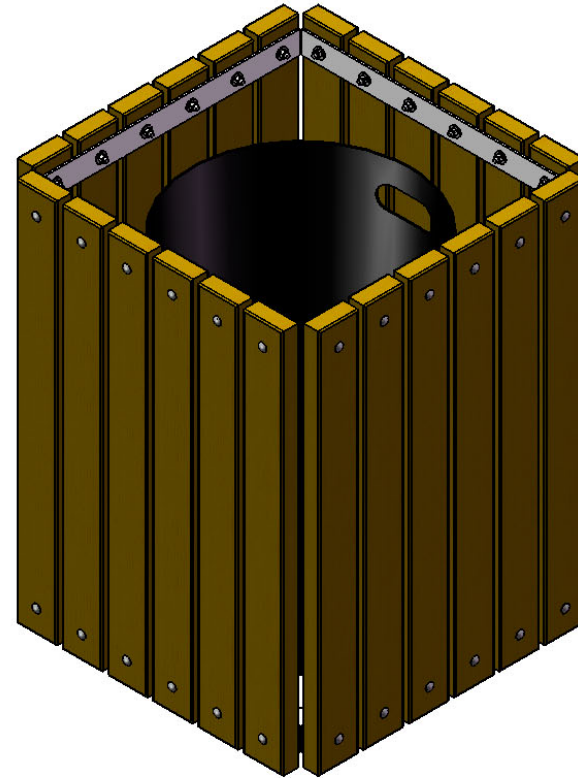
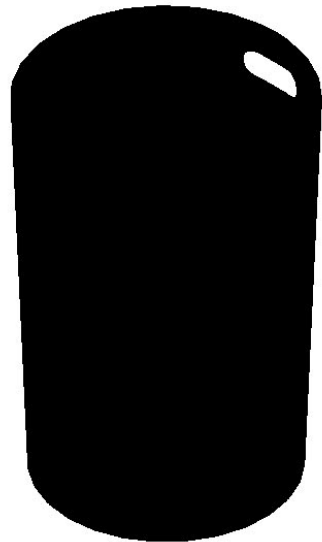

TOP DIMENSIONS

AU-32-TRSQ ASH URN TOP

Material: Top shall be fabricated from 18 gauge steel flat and bent to form. Vertical posts are 1/2" diameter rod. Bonnet top and ash urn shall be fabricated from 20 gauge steel flat, spun to form. All electrically mig welded.

Coating: Electrostatic powder coated application oven cured.

Dimensions: Hole shall be an 8" inside diameter. Overall dimensions shall be 24" square x 11-1/4" high.

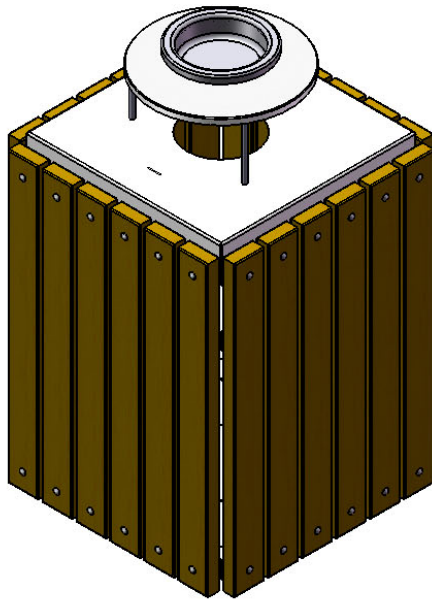

FT-32-TRSQ FLAT TOP

Material: Top shall be fabricated from 18 gauge steel flat and bent to form.

Coating: Electrostatic powder coated application oven cured.

Dimensions: Hole Shall be an 8" inside diameter. Overall dimensions shall be 24" square x 2" high.

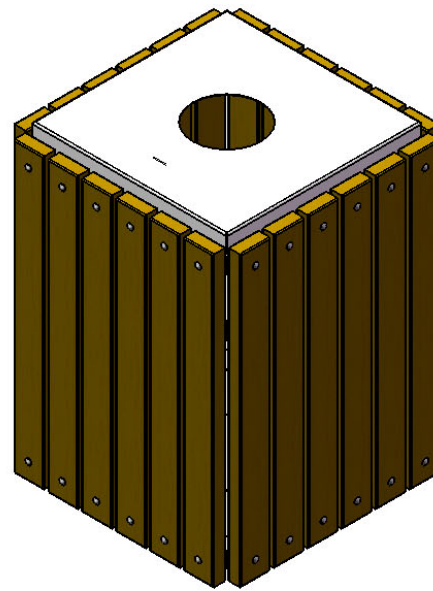

RB-32-TRSQ RAIN BONNET TOP

Material: Top shall be fabricated from 18 gauge steel flat and bent to form. Rain Bonnet shall be fabricated from 20 gauge steel flat, spun to form. All electrically mig welded.

Coating: Electrostatic powder coated application oven cured.

Dimensions: Hole shall be an 8" inside diameter. Overall dimensions shall be 24" square x 11" high.

